

# HSE ROHS

## SPECIFICATIONS

Rated Current: 5.0AMP  
 Contact Resistance: 20mΩ Max  
 Withstand Voltage: 500V AC/DC  
 Insulation Resistance: 1000MΩ Min  
 Operation Temperature: -40°C to +105°C  
 Contact Material: Brass  
 Contact Plating: Sn Over Ni  
 Insulator Material: Polyester (UL94V-0)  
 Standard: LCP  
 Max. Processing Temp: 230°C for 30-60 seconds  
 (260°C for 5 seconds)

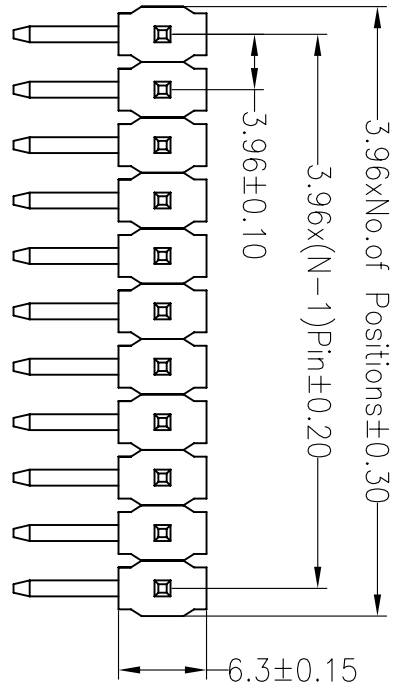

Recommended P.C.B Layout (Top Side)  
 (PCB BOARD TOLERANCE ±0.05)

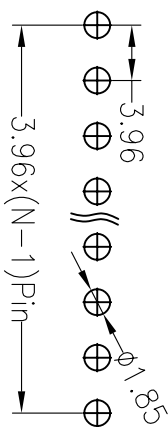

## Ordering Information

1932 11 XX F N XX R XXX X 01

No. of Pins Per Row: 1x1~1x20  
 Insulator Material Option:  
 A=BK-PBT  
 B=BK-PA66  
 C=BK-PA6T  
 D=BK-PA46  
 F=BK-LCP  
 Contact Plating:  
 G0:Gold Flash  
 G2:5U" Gold  
 G3:10U" Gold  
 G4:15U" Gold  
 G5:30U" Gold  
 S0:Gold Flash/Tin  
 SN:Tin  
 SM:Matte-Tin  
 Packing:  
 0=PE Bag  
 A=Troy  
 T=Tube

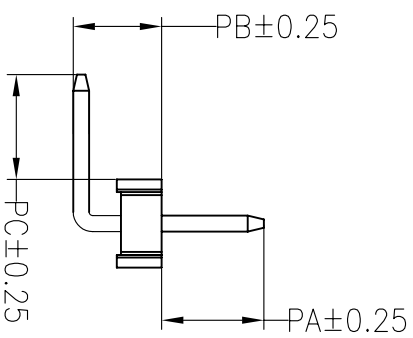
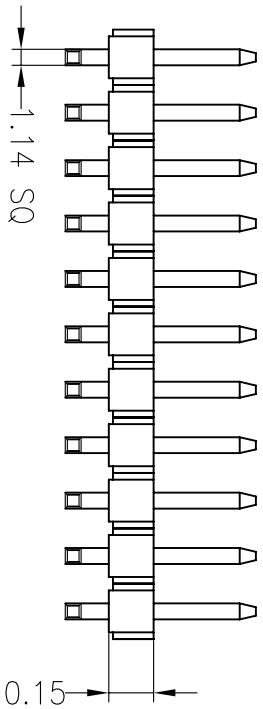

ITEM	PA	PB	PC	L
Standard	8.00	6.50	3.50	20.3
Alternate				

OPERATION		DRAW		SCALE		FIT		PART NO.	
X.X	±0.30	Ben	12.04.11	UNIT	mm	A4	1/1	193211XXFNXXXXX01	
X.XX	±0.20	CHECK		SIZE	A4	SHEET	1/1	TITILE: 3.96PH 1xNpin H3.2mm 90°	
X.XXX	±0.10	APPROVE		PROJ.					
Angle	±3°								
DIM	TOL								

**JIN** 深圳市锦凌电子有限公司  
 SHENZHEN JINLING ELECTRONIC CO.,LTD  
 Tel: 86-755-2997-5806/5802 Fax: 86-755-2997-5992